

Adjustable Steel Strap for 12 Inch E-Z Boot

Requires 2 Assemblies per
E-Z Boot

Weld Coupling Nut as shown
is on both sides of boot.

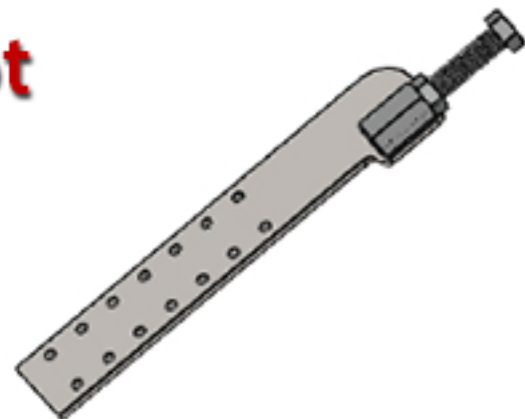

5/8-11 JAM NUT

5/8-11 FULL THREAD BOLT X 4" LONG

0.188

5/8-11 COUPLING NUT

1.193



ADJUSTABLE STEEL STRAP
FOR 12 INCH EZ-BOOT

WELD

WELD

